

Freud Router Bits: 99-566, 99-569, 99-571, 99-500

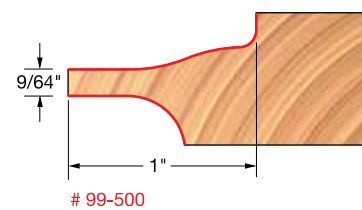

Steps To Building A Perfect Panel Door

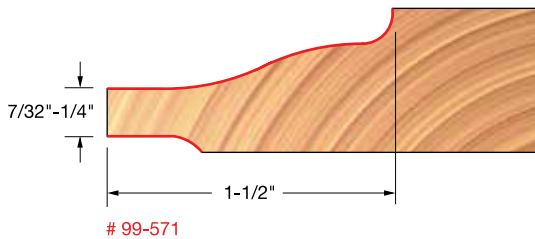
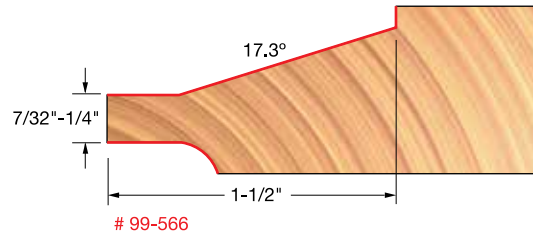
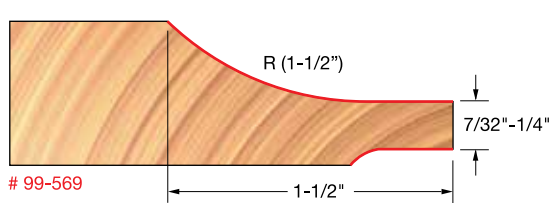
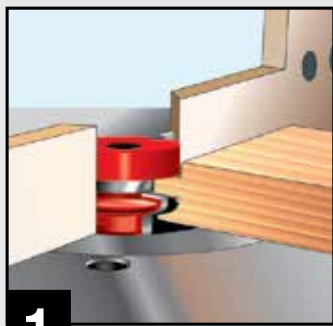

1 Cut rail ends. Bit shown is from Freud set #99-760.

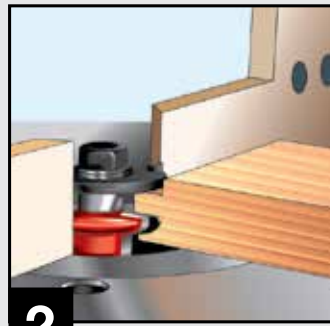
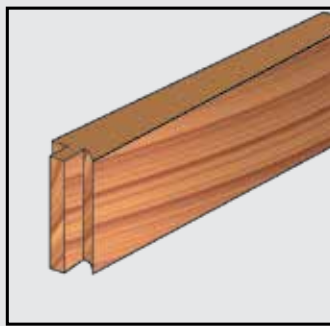

2 Rout stiles & rails. Bit shown is from Freud set #99-760.

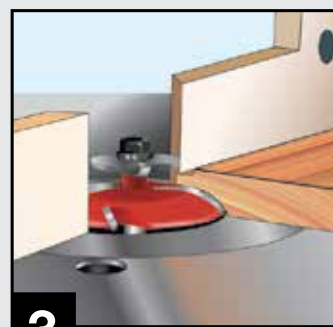
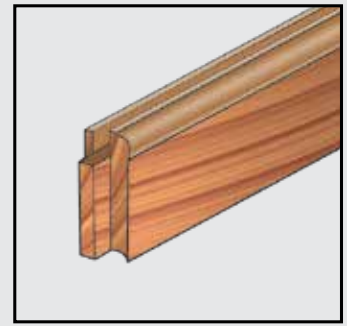

3 In one step, cut door panel profile and back cut. Quadra-Cut™ Raised Panel Bit shown is the #99-569.

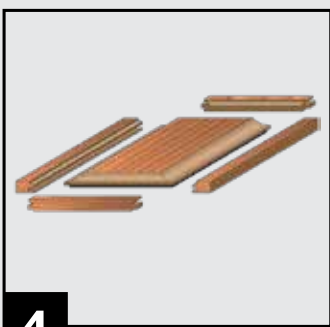
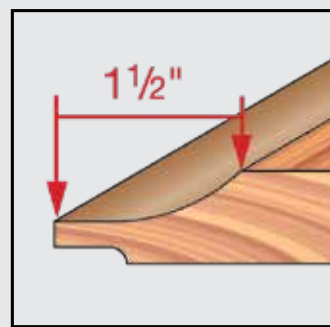

4 Assemble stiles, rails and door panel.

